

ENDEAVOUR

1080 Kitigan Grove, Kanata



Kanata Lakes

Phase 9 / Lot 168 / Block 22

3 Bedroom and 2.5 Bath with Loft Layout

2,055 SQ FT

~~\$822,900~~ **\$772,900**

Contact

Leigh-Ann Shearer - Sales Consultant

kanatalakes@urbandale.com

613-822-2190

Move In Soon Townhome (Spring 2026)

- Designer Finished - Interior Unit
- Oak hardwood stairs from main floor to bedroom floor
- Oak railing in loft in lieu of half wall
- 3x5 shower in bath 1
- Upgraded quartz countertop in kitchen and bath 1
- Upgraded hood fan with cabinet box
- Matte black faucets in kitchen and powder room
- Upgraded tile backsplash in kitchen
- Upgraded interior door hardware throughout

Net-Zero Ready

Urbandale is paving the way to create resilient, comfortable, and low carbon communities in the Capital region. Net Zero Ready homes are optimized with technology that ensures comfort, lower cost of home ownership, exceptional air quality, durability, and helps offset energy costs.

GROUND FLOOR

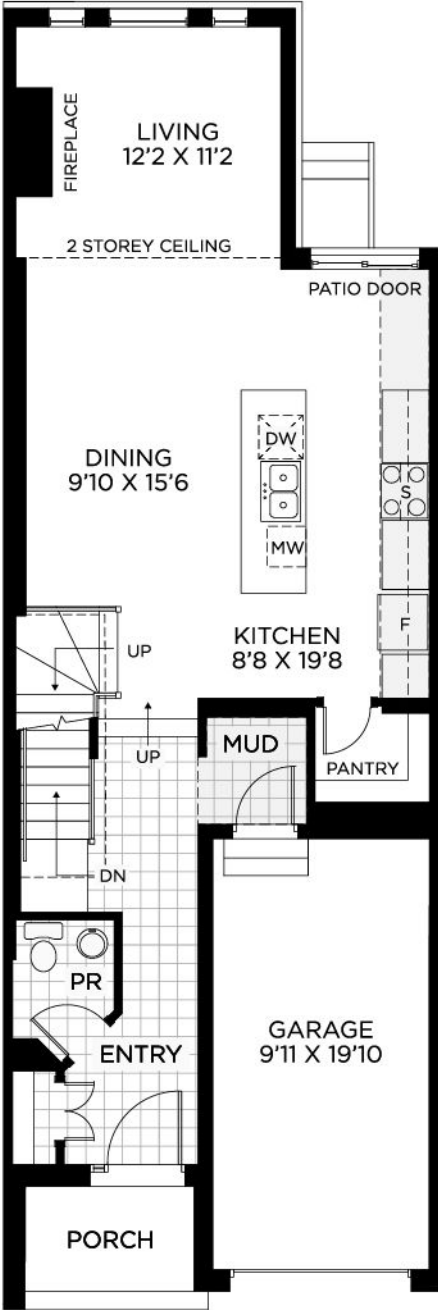

BEDROOM FLOOR



BASEMENT

